

### 构造图 Construction

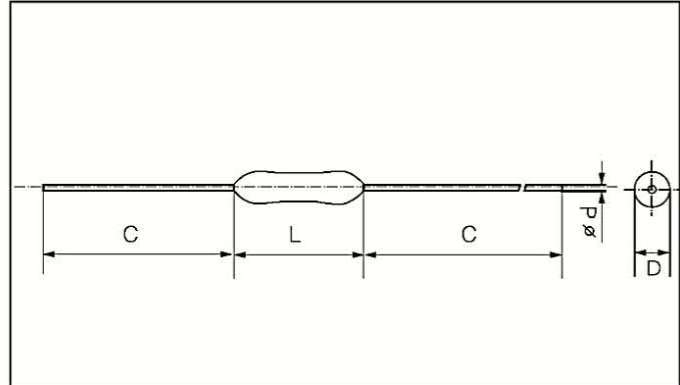

### 产品特点 Features

- 高稳定, 高精度, 低温漂
- 温度范围:  $-65^{\circ}\text{C}\sim 150^{\circ}\text{C}$
- 稳定度:  $\pm 0.5\%$ ,  $125^{\circ}\text{C}$ , 1000h
- 涂覆型
- High stability, high precision, low TCR
- Temperature range:  $-65^{\circ}\text{C}\sim 150^{\circ}\text{C}$
- Stability:  $\pm 0.5\%$ ,  $125^{\circ}\text{C}$ , 1000h
- Coated style

### 外形尺寸 Dimensions (mm)

| 尺寸(size) | $L\pm 0.3$ | $D\pm 0.3$ | $C\pm 2$ | $d\pm 0.05$ |
|----------|------------|------------|----------|-------------|
| RE1/8    | 3.80       | 1.50       | 26       | 0.50        |
| RE1/6    | 6.20       | 1.80       | 36       | 0.60        |
| RE1/4    | 9.10       | 2.10       | 36       | 0.60        |
| RE1/2    | 13.1       | 4.00       | 36       | 0.60        |
| RE3/4    | 15.5       | 5.00       | 36       | 0.80        |

### 应用范围 Applications

- 仪器仪表
- 电子衡器
- 航天航空
- 国防
- Meters and instruments
- Electronic weighing apparatus
- Aviation and aerospace
- Military project

### 降功耗曲线 Derating Curve

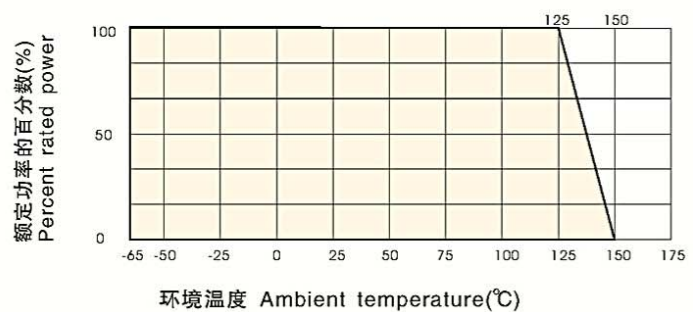

### 执行标准 Reference Standards

GJB1929-1994

### 技术说明 Technical Specifications

| 型号<br>Type          | 在不同温度下的额定功率(W)<br>Power Rating at tu $^{\circ}\text{C}$ (W) |                        |                        | 最大工作电压<br>Max Working Voltage (V) | 阻值范围<br>Resistance Range | 精度范围<br>Tolerance Range   | 温度系数范围<br>TCR (ppm/ $^{\circ}\text{C}$ )  |
|---------------------|---|------------------------|------------------------|-----------------------------------|--------------------------|---|---|
|                     | 70 $^{\circ}\text{C}$                                       | 100 $^{\circ}\text{C}$ | 125 $^{\circ}\text{C}$ |                                   |                          |   |   |
| RE1/8,RJ52 $\Delta$ | 0.15  | 0.10                   | 0.05                   | 200                               | 10R~1M5                  | P( $\pm 0.02\%$ ), W( $\pm 0.05\%$ ),<br>B( $\pm 0.1\%$ ), C( $\pm 0.25\%$ ),<br>D( $\pm 0.5\%$ ), F( $\pm 1.0\%$ ) | C7( $\pm 5$ ), C6( $\pm 10$ ),<br>C5( $\pm 15$ ), C4( $\pm 20$ ),<br>C3( $\pm 25$ ), C2( $\pm 50$ ) |
| RE1/6,RJ53 $\Delta$ | 0.25  | 0.15                   | 0.10                   | 200                               | 0R1~5M                   |   |   |
| RE1/4,RJ54 $\Delta$ | 0.50  | 0.25                   | 0.125                  | 250                               | 0R1~10M                  |   |   |
| RE1/2,RJ55 $\Delta$ | 0.75  | 0.50                   | 0.25                   | 300                               | 0R1~5M0                  |   |   |
| RE3/4,RJ56 $\Delta$ | 1.0   | 0.75                   | 0.50                   | 350                               | 0R1~10M                  |   |   |

# RE 高稳定精密金属膜电阻器

## high stability precision metal film resistors



### 性能指标 Performance

| 试验项目 Test Item            | 性能要求 Specifications            | 试验方法 Test Method                       |
|---------------------------|--------------------------------|--|
| 过载 Short time overload    | $\leq \pm(0.25\%R+0.05\Omega)$ | 2.5V <sub>R</sub> , 5s                 |
| 温度冲击 Thermal shock        | $\leq \pm(0.25\%R+0.05\Omega)$ | -65°C~150°C, 5cycles, 0.5h             |
| 低温工作 Low temp. operation  | $\leq \pm(0.25\%R+0.05\Omega)$ | -65°C, P <sub>R</sub> , 1h             |
| 介质耐压 Dielectric strength  | $\leq \pm(0.25\%R+0.05\Omega)$ | V <sub>AC</sub> , 1min                 |
| 耐焊接热 Leaching             | $\leq \pm(0.1\%R+0.05\Omega)$  | 260°C, 10s                             |
| 耐湿 Resistance to moisture | $\leq \pm(0.5\%R+0.05\Omega)$  | -10°C~65°C, RH80~98%, 240h             |
| 寿命 Load life              | $\leq \pm(0.5\%R+0.05\Omega)$  | 125°C, P <sub>R</sub> , 1000h          |
| 冲击 Shock                  | $\leq \pm(0.25\%R+0.05\Omega)$ | 1000m/s <sup>2</sup> , 6ms             |
| 振动 Vibration              | $\leq \pm(0.25\%R+0.05\Omega)$ | 10~2000Hz, 0.75mm, 200m/s <sup>2</sup> |

### 产品精度、温度系数与阻值范围对照表

#### Electrical data-Tolerance, TCR & Resistance range

| 产品型号及规格型号 Type |                            |        | RE1/8<br>RJ52 $\Delta$ | RE1/6<br>RJ53 $\Delta$ | RE1/4<br>RJ54 $\Delta$ | RE1/2<br>RJ55 $\Delta$ | RE3/4<br>RJ56 $\Delta$ |
|----------------|----------------------------|--------|------------------------|------------------------|------------------------|------------------------|------------------------|
| 代码 P           | 阻值精度 $\pm 0.02\%$          | 最低FROM |                        | 10R                    | 10R                    | 100R/300R              | 100R/300R              |
|                |                            | 最高TO   |                        | 500K                   | 500K                   | 1M0                    | 1M0                    |
| W              | $\pm 0.05\%$               | 最低FROM | 50R                    | 10R                    | 10R                    | 50R                    | 50R                    |
|                |                            | 最高TO   | 750K                   | 1M0                    | 1M0                    | 1M0                    | 2M0                    |
| B              | $\pm 0.1\%$                | 最低FROM | 10R                    | 1R0                    | 1R0                    | 1R0                    | 1R0                    |
|                |                            | 最高TO   | 1M0                    | 3M0                    | 3M0                    | 4M0                    | 10M                    |
| C              | $\pm 0.25\%$               | 最低FROM | 10R                    | 1R0                    | 1R0                    | 1R0                    | 1R0                    |
|                |                            | 最高TO   | 1M0                    | 5M0                    | 10M                    | 5M0                    | 10M                    |
| D              | $\pm 0.5\%$                | 最低FROM | 10R                    | 0R5                    | 0R5                    | 0R5                    | 0R5                    |
|                |                            | 最高TO   | 1M0                    | 5M0                    | 10M                    | 5M0                    | 10M                    |
| F              | $\pm 1.0\%$                | 最低FROM | 10R                    | 0R1                    | 0R1                    | 0R1                    | 0R1                    |
|                |                            | 最高TO   | 1M5                    | 5M0                    | 10M                    | 5M0                    | 10M                    |
| C7             | 温度系数TCR $\pm 5(10^{-6}/K)$ | 最低FROM |                        | 5R0                    | 5R0                    | 5R0                    | 5R0                    |
|                |                            | 最高TO   |                        | 1M0                    | 1M0                    | 500K                   | 500K                   |
| C6             | $\pm 10(10^{-6}/K)$        | 最低FROM | 10R                    | 1R0                    | 1R0                    | 1R0                    | 1R0                    |
|                |                            | 最高TO   | 750K                   | 1M0                    | 1M0                    | 750K                   | 750K                   |
| C5             | $\pm 15(10^{-6}/K)$        | 最低FROM | 10R                    | 1R0                    | 1R0                    | 1R0                    | 1R0                    |
|                |                            | 最高TO   | 1M0                    | 4M0                    | 5M0                    | 3M0                    | 5M0                    |
| C4             | $\pm 20(10^{-6}/K)$        | 最低FROM | 10R                    | 1R0                    | 1R0                    | 1R0                    | 1R0                    |
|                |                            | 最高TO   | 1M5                    | 5M0                    | 10M                    | 5M0                    | 10M                    |
| C3             | $\pm 25(10^{-6}/K)$        | 最低FROM | 10R                    | 1R0                    | 1R0                    | 1R0                    | 1R0                    |
|                |                            | 最高TO   | 1M5                    | 5M0                    | 10M                    | 5M0                    | 10M                    |
| C2             | $\pm 50(10^{-6}/K)$        | 最低FROM | 10R                    | 1R                     | 1R                     | 1R                     | 1R                     |
|                |                            | 最高TO   | 1M5                    | 5M0                    | 10M                    | 5M0                    | 10M                    |

### 订货示例 How To Order

例如 Example

|              |                                 |                                       |                       |   |   |                   |
|--------------|---------------------------------|---------------------------------------|-----------------------|---|---|-------------------|
| RE           | 1/8                             | 0.15W                                 | 10K                   | $\pm 0.05\%$                                | $\pm 20\text{ppm}$  | 盒装 Boxes          |
| 产品型号<br>Type | 类型<br>Style                     | 功率<br>Power                           | 标称阻值<br>Nominal Value | 精度<br>Tolerance                             | 温度系数<br>TCR   | 包装方式<br>Packaging |
| RE           | 1/8<br>1/6<br>1/4<br>1/2<br>3/4 | 0.15W<br>0.25W<br>0.5W<br>0.75W<br>1W | 10M                   | $\pm 0.02\%$<br>$\pm 0.05\%$<br>$\pm 0.1\%$ | $\pm 5\text{ppm}$<br>$\pm 10\text{ppm}$<br>$\pm 15\text{ppm}$<br>$\pm 20\text{ppm}$<br>$\pm 25$<br>$\pm 50$ | 盒装 boxes          |

包装说明：包装塑料自封袋包装（起订量30只）。 Packaging: Plastic recloseable bags (moq: 30pcs)。